

FED. ROAD DIV. No.	STATE	F A PROJECT NO.	FISCAL YEAR	SHEET No.
3	FLA.			

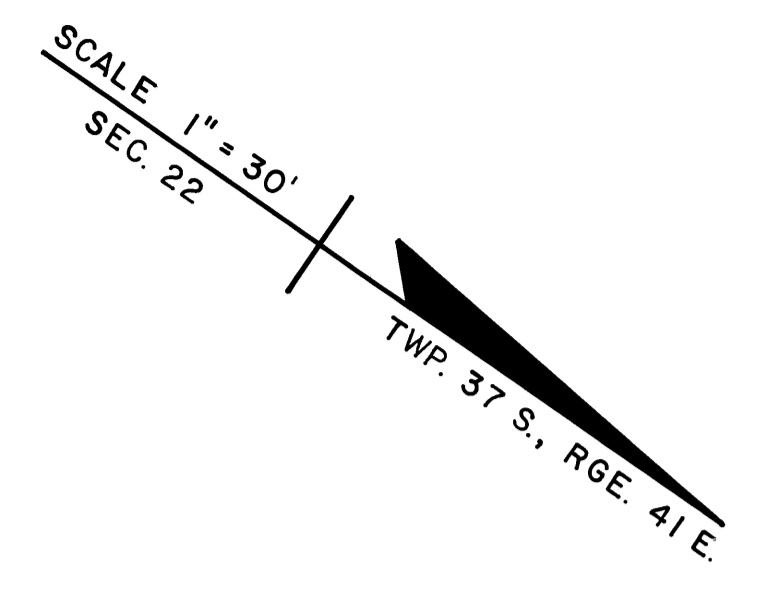
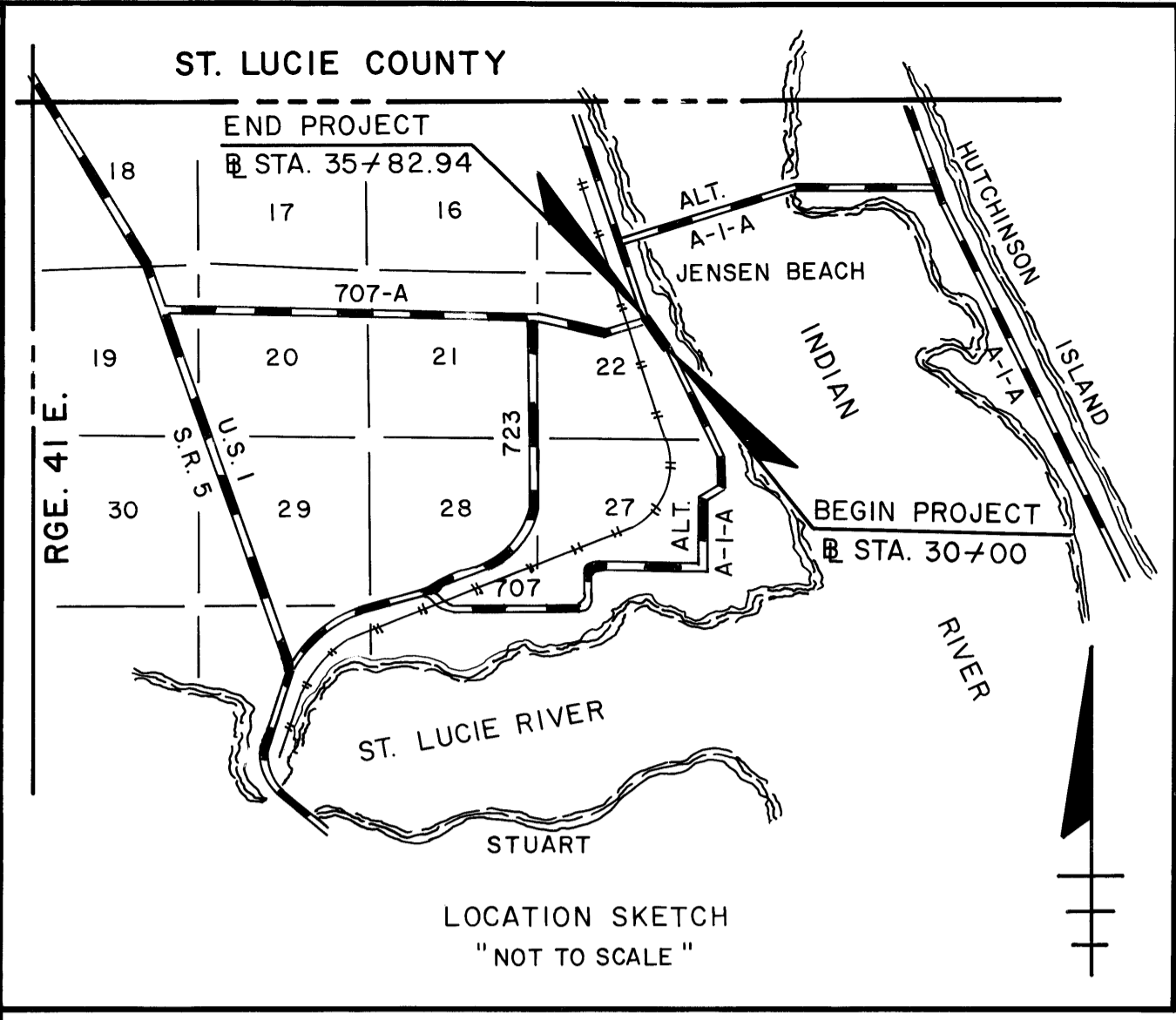

PL B 8
PG 33
P.T. STA. 153+30.04
S.R. 707-A
89530-2152

BEGIN PROJECT
@ STA. 30+00

END PROJECT
@ STA. 35+82.94 S.R. 707 =
@ STA. 164+60.00 S.R. 707-A
89530-2152

MAINT. R/W TABULATION

STA.	LEFT	RIGHT
30+00	17'	17'
31+00	19'	17'
31+50	19'	18'
32+00	19'	18'
32+88		18' BK.
		13.4' AHD.
33+00	19'	13.4' BK. CURB
34+00	24'	6.5' BK. CURB
34+00	27'	5.0' BK. CURB
35+00	27'	5.4' BK. CURB
35+50	27'	8'
35+82.94	27'	14'

REFERENCES:
BEARING—89530-2152 S.R. 707-A
SURVEY BOOK NO. 1023563

P.I. STA. 32+97.97
Δ = 8°08'51" RT.

STATE OF FLORIDA
DEPARTMENT OF TRANSPORTATION
MAINTENANCE MAP

STATE ROAD NO. 707 MARTIN COUNTY

DRAWN	STOUT	DATE	5-7-80
TRACED	STOUT	DATE	7-15-80
CHECKED	GRAY	DATE	7-15-80
COMPARED			
INDEXED			

APPROVED: *William E. Martin* DISTRICT ENGINEER
W.A. Paulina 8-6-80 ENGINEER OF RIGHT OF WAY

SECTION 89030 SHEET 2 OF 2

REVISION	BY	DATE